

How to install: Awning Window

INSTALLATION INSTRUCTIONS

Your Window can be installed in any one of 4 configurations: a hopper (Fig.1) an awning (Fig. 2), a left or right hinged casement (Fig. 3)

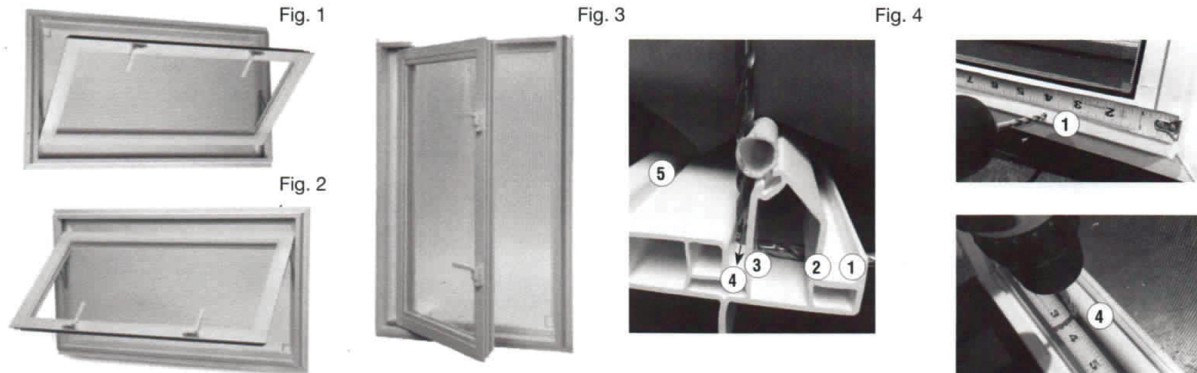

After determining the configuration you will be installing your new window, we recommend you drill 4 holes for proper water drainage of your new window. You will need a power drill with an 3/16" drill bit. All holes will be drilled in the sill of the window as shown in Fig. 4. First drill 2 horizontal holes approx. 4" from each end (Holes ①, ②, ③) Making sure to drill through the 3 walls of PVC as shown in Fig. 4 (1-1/4" into the frame) Next, drill 2 vertical holes (Hole ④), spaced evenly along the sill of the window. **These holes should only be drilled through a single wall of PVC! DO NOT drill through the bottom of the sill!** Next install the window into your wall opening and secure through the jambs using a pan head screw in the recessed area around the frame area ⑤ or nail fin. Use a high quality pure silicone to seal your window around the perimeter.

9326 Hwy 90 Longs SC, 28568 • shedwindowsandmore.com • (843) 399 - 1820

 **Shed Windows and More®**

How to install: Awning Window

INSTALLATION INSTRUCTIONS

Your Window can be installed in any one of 4 configurations: a hopper (Fig.1) an awning (Fig. 2), a left or right hinged casement (Fig. 3)

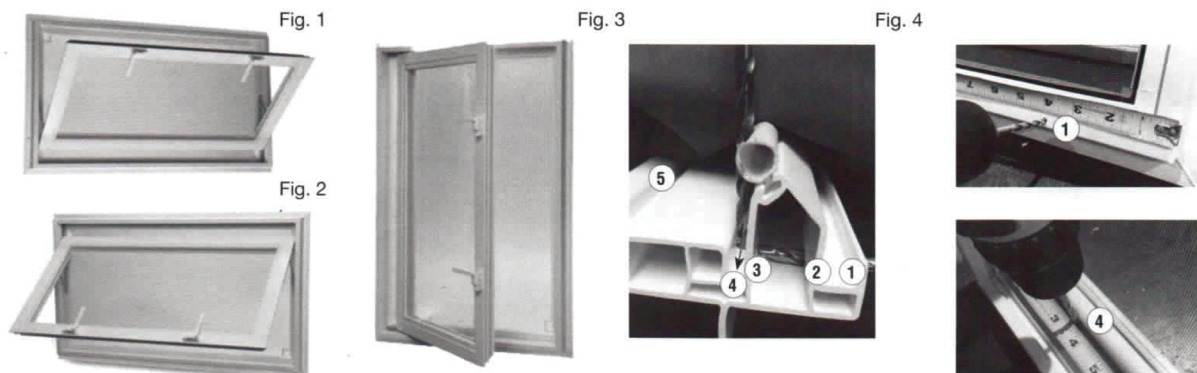

After determining the configuration you will be installing your new window, we recommend you drill 4 holes for proper water drainage of your new window. You will need a power drill with an 3/16" drill bit. All holes will be drilled in the sill of the window as shown in Fig. 4. First drill 2 horizontal holes approx. 4" from each end (Holes ①, ②, ③) Making sure to drill through the 3 walls of PVC as shown in Fig. 4 (1-1/4" into the frame) Next, drill 2 vertical holes (Hole ④), spaced evenly along the sill of the window. **These holes should only be drilled through a single wall of PVC! DO NOT drill through the bottom of the sill!** Next install the window into your wall opening and secure through the jambs using a pan head screw in the recessed area around the frame area ⑤ or nail fin. Use a high quality pure silicone to seal your window around the perimeter.

9326 Hwy 90 Longs SC, 28568 • shedwindowsandmore.com • (843) 399 - 1820

 **Shed Windows and More®**